

MICROFILMED

- 12 -

- 14 -

M 6-23E  
130.0'

PART-13.

SEWER EASEMENT LOCATION  
TAKEN FROM PLAT BY  
JONES ENGINEERING DATED  
9/18/72 RECORDED IN PLAT  
BOOK 44 PAGE 134

SAN. SEWER

Note: Improvements on this  
lot are not in a flood  
hazard area.

SEWER  
LINE

231.2

186-08 W

249.2

576-24E

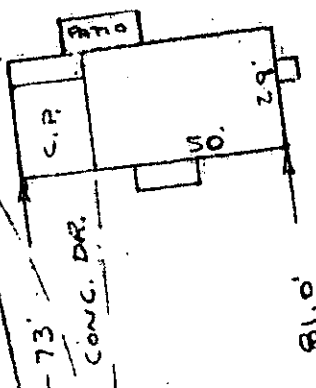

PART-13.

432.5

WOOD CIRCLE  
WATER IN ST RW.

EAST LEE  
ROAD

PROPERTY OF  
DAVID B. ROVNER  
NEAR GREENVILLE, S.C.  
SCALE 1" = 50' 9 JAN 1980

FILED  
JAN 23 9 18 AM '80  
DONNIE STANKERSLEY  
R.H.C.

This is to certify that on the 9th day of January, 1980, I surveyed the property shown on this plat, being known as greater portion of lot 13 on plat of REVISED PLAT OF WOOD CIRCLE and recorded in the EMC Office Greenville County, S. C., in Plat Book "WW" at Page 54; and that the property lines, walls and buildings are as shown hereon, and that the walls and buildings located on said lot do not encroach or project on adjacent street or property, and that no adjacent walls or buildings encroach or project on said premises, and no power lines cross this property except as shown hereon.

7-T-69 ✓ 22810

R. B. Bruce  
R. B. Bruce, RLS #1952

CAROLINA SURVEYING CO.  
112 Manly St. 80  
Greenville, S. C.

3.00CT

217/48

T 33-1 171

JAN 25 1980